

**ORDINANCE
2005-41**

**AN ORDINANCE ADOPTING A FUTURE LAND USE
MAP AMENDMENT TO THE WALTON COUNTY
COMPREHENSIVE PLAN; SETTING FORTH THE
AUTHORITY FOR ADOPTION; PROVIDING FOR
SEVERABILITY; AND PROVIDING FOR AN
EFFECTIVE DATE.**

WHEREAS, Chapter 163, Florida Statutes establishes the Local Government Comprehensive Planning and Land Development Regulation Act; and,

WHEREAS, Chapter 163, Florida Statutes requires local governments desiring to amend their comprehensive plan to prepare and adopt an amendment; and,

WHEREAS, Walton County has prepared a comprehensive plan map amendment for an unincorporated area of the county; and,

WHEREAS, Walton County held the requisite public hearings to afford public comment and to consider approval and adoption of the map amendment; and,

NOW THEREFORE BE IT ORDAINED BY THE BOARD OF COUNTY COMMISSIONERS OF WALTON COUNTY, FLORIDA, THAT:

Section I. This ordinance shall be known as the Walton County Comprehensive Plan Map Amendment # 05-O1-B.2.2.

Section II. The Walton County Comprehensive Plan Future Land Use Map is hereby amended changing Parcel Number(s) 30-2S-21-42000-002-0000 consisting of approximately 35.45 acres from Neighborhood Planning Area I Residential Preservation (NPNRP) to Coastal Center (CC), located in the northern portion of the Golf Garden.

Section III. An official, true and correct copy of the Future Land Use Map and amendments shall be filed with the Walton County Clerk and also maintained at the Walton County Planning and Development Services Division, which shall be responsible for the administration of the Comprehensive Plan.

Section IV. Severability. If any portion of this Ordinance should be declared unconstitutional or if the applicability of this Ordinance or any portion thereof should be held to be invalid, the validity of the remainder of the Ordinance shall not be affected by such invalidity.

Section V. Effective date. This Ordinance shall become effective as provided by law.

ADOPTED THIS 20th DAY OF November, 2005.

ATTEST:

Crystal Scomiers
Clerk of Courts

Scott A. Brannon
Scott Brannon, Chairman
Board of County Commissioners
Walton County, Florida

LSA_05-01- B.2.2

Total Acreage: 35.45

From: NPA/RP
To: Coastal Center



- Streets
- Parcels
- Amendments

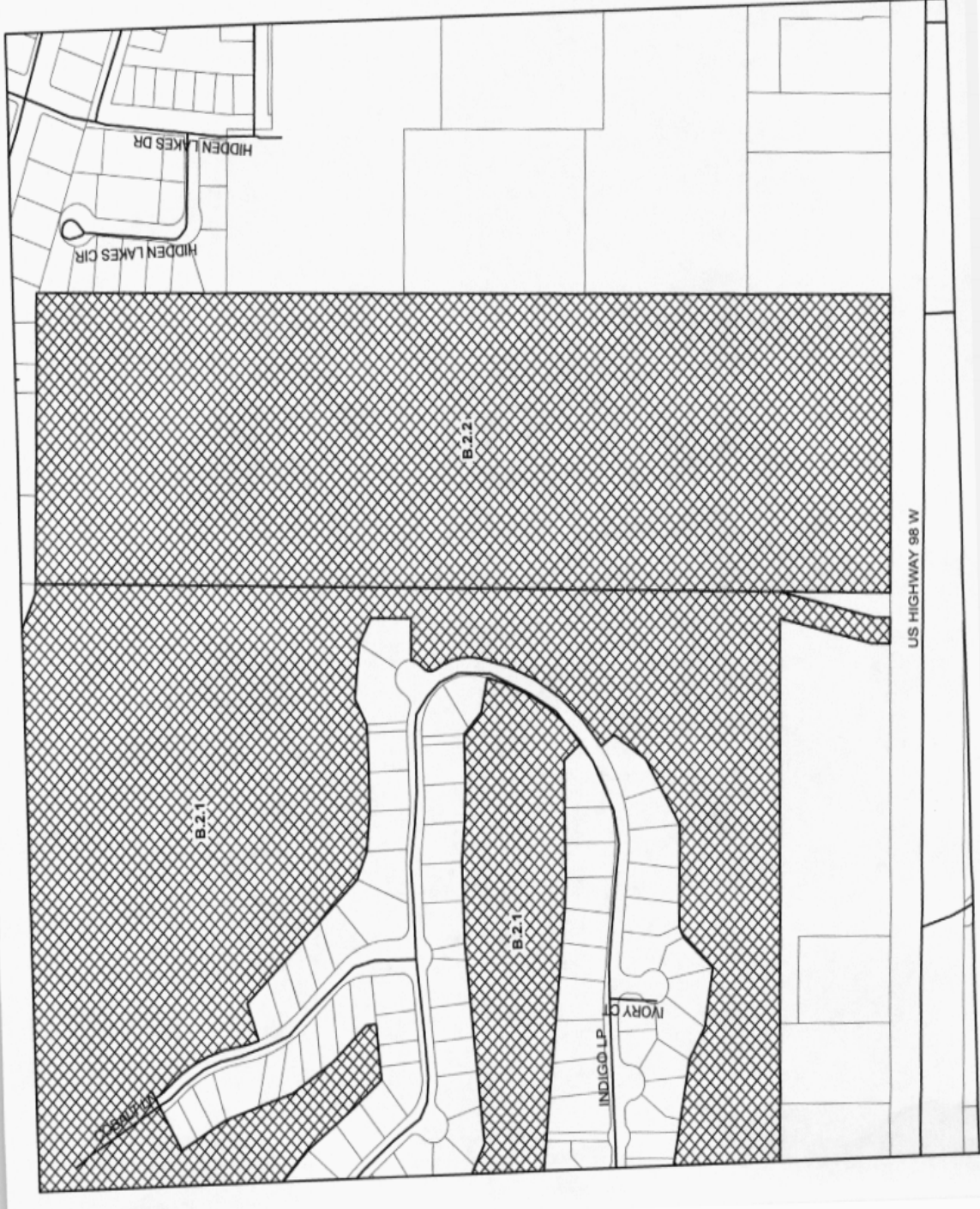

Copyright 2005 by the State of Florida, Department of Transportation. All rights reserved. This map is a preliminary map and is not intended to be used for any purpose other than for informational purposes. The State of Florida, Department of Transportation, does not warrant the accuracy or completeness of the information shown on this map. The user of this map assumes all liability for any errors or omissions. This map is not to be used for any other purpose.